



SERVICE INFORMATION LETTER

SIL T-060
Revision 2
Page 1 of 7

- DATE: August 21, 2019
1. SUBJECT: AeroLEDs Sunspot 36HX Landing Light Upgrade
 2. MODEL: 480B
 3. EFFECTIVITY: S/N 5136-5239
 4. REFERENCE: Enstrom TH-28/480 Series Illustrated Parts Catalog, Rev. 14 or Later Revision
 5. BACKGROUND:

Enstrom helicopters configured with the AeroLEDs Sunspot 36HX landing light, P/N 01-1030-H-A-P, may upgrade to the newer version, P/N 01-1030-H-A-P Rev. C, by incorporating kit P/N 4230090-1. This upgrade is required if the original landing light P/N 01-1030-H-A-P needs replacement.

The Rev. C version of the landing light features a keyway (Figure 1) to ensure the light assembly is installed in the proper orientation. If upgrading from a Rev. A or Rev. B landing light assembly to a Rev. C version, the holder plate requires modification to fit the keyway.

The kit includes the landing light assembly, a wire assembly, and a holder assembly to complete the installation. The key characteristics of the new landing light version are a redesign of the electrical attachment to include screw terminals and a slight change in the size of the retention (holder) plate.

This Service Information Letter (SIL) is intended to make operators aware that the landing light replacement kit, P/N 4230090-1, is available and to provide instructions to perform the installation. Additionally, this SIL provides instructions for modifying the holder plate when upgrading from a Rev. A or Rev. B landing light assembly to a Rev. C assembly.

August 21, 2019

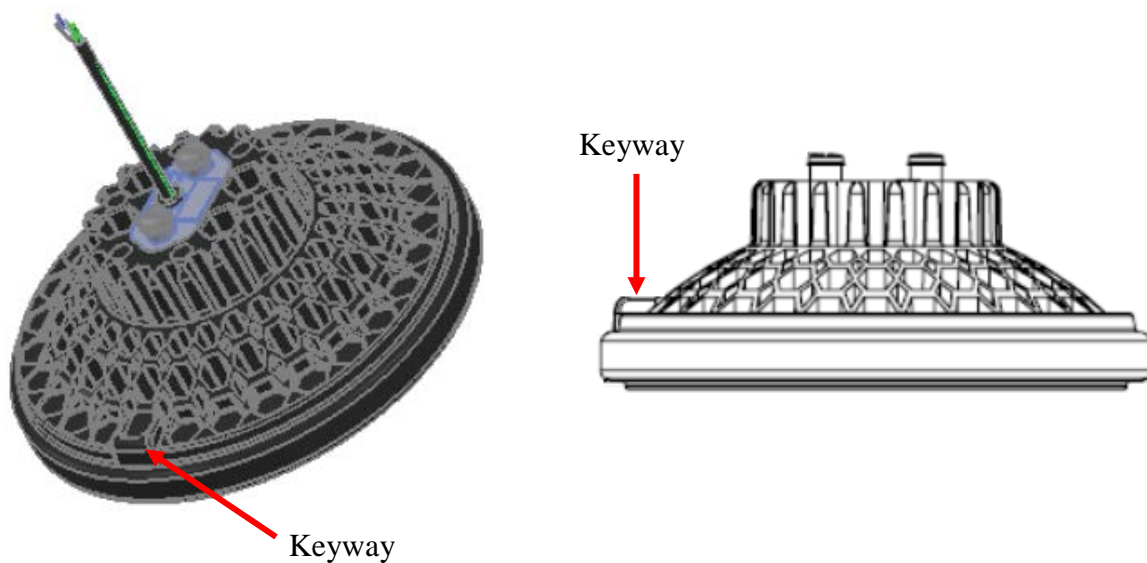

Figure 1. P/N 01-1030-H-A-P, Rev. C Landing Light

6. COMPLIANCE:

At owner/operator option, or if the original landing light (P/N 01-1030-H-A-P) requires replacement, install kit P/N 4230090-1 in accordance with paragraph 6.1. For helicopters configured with Rev. A or Rev. B of P/N 01-1030-H-A-P per previous issue of this SIL, modify the holder in accordance with paragraph 6.2.

NOTE: Refer to Enstrom kit drawing 4230090-1 for installation detail.

When upgrading from a Rev. A or Rev. B landing light assembly to a Rev. C assembly, refer to step 6.2 for modification instructions.

All installation hardware is supplied with the kit, unless otherwise noted.

All electrical attachments, cable installation and supports for routing shall meet the standard acceptable practices defined in AC43.13-1B, AC21.99, and Enstrom Document 28-SP-133 (28-SP-133 is included with the kit.).

Paint/painting is the installer's responsibility.

6.1 Upgrading P/N 01-1030-H-A-P landing light to Rev. C:

6.1.1 Remove the landing light stop by removing the two attachment screws.

6.1.2 Press the landing light position switch DOWN until the landing light is fully extended (downward).

- 6.1.3 Remove electrical power from the aircraft and implement any local safety measures to ensure power is not inadvertently applied.
 - 6.1.4 Remove the existing bezel (P/N 4212103-25).
 - 6.1.4.1 Remove screws AN526-632R7 (4x). Discard the screws.
 - 6.1.4.2 Remove the bezel. Discard the bezel.
 - 6.1.5 Remove the existing landing light.
 - 6.1.5.1 Pull the landing light assembly forward to access the wiring.
 - 6.1.5.2 Cut the wiring between the landing light wiring connector and the aircraft wire harness.
 - 6.1.5.3 Remove the landing light assembly.
 - 6.1.6 Remove the existing holder assembly (P/N 4212103-29).
 - 6.1.6.1 Remove the hardware that attaches the link (P/N 4212103-23) to the servo actuator (AN526-632R8 screw (1x), AN960-6L washers (2x), AN364-632A nut). Retain the hardware.
 - 6.1.6.2 Locate the four (4) rivets that attach the holder assembly to the hinge. Drill out the rivets.
 - 6.1.6.3 Remove the holder assembly. Discard the holder assembly.
- NOTE: Route wires to the existing wire harness. Trim wires supplied with the kit and mate to the existing wire harness as required at installation. Ensure wire connections to the correct terminals. (The label '+' on the back of the landing light assembly is difficult to see.)**
- 6.1.7 Install wire assembly (P/N 4230090-5).
 - 6.1.7.1 Ensure the YE, GR, and BL wires are wrapped with shrink tube (Figure 2).
 - 6.1.7.2 Ensure the wire ends are labeled on the 4230090-5 wire assembly with wire markers (1L101A14 and 1L102A14N) (Figure 3).
 - 6.1.7.3 Splice the 4230090-5 assembly wires (1L101A14 and 1L102A14N) to the aircraft wiring harness. Refer to kit supplied electrical wiring diagram 4192513-15 for completing the wiring interface.
 - 6.1.7.4 Install terminal rings to the 1L101A14 and 1L102A14N wire ends (2x).
 - 6.1.7.5 Wrap wire bundle with kit-supplied SE25PFR-MR0 sleeving. Trim as required (Figure 4).

August 21, 2019



Figure 2. Wires wrapped with shrink tube (Rev. A shown)

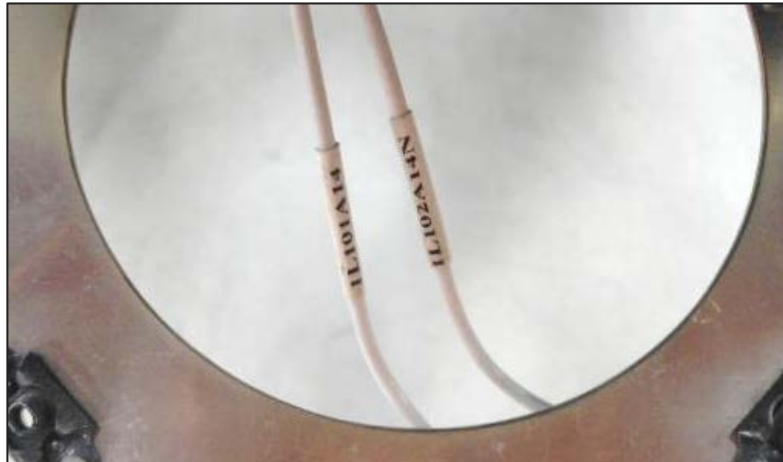

Figure 3. Wire labels



Figure 4. Wire bundle with sleeving (Rev. A shown)

August 21, 2019

6.1.8 Install new holder assembly (P/N 4230090-3, excluding bezel clamp).

6.1.8.1 Place the holder assembly onto the hinge. Match the four Ø.094 holes in the holder assembly to the holes in the hinge (holder assembly nutplates to the inside).

6.1.8.2 Rivet the holder assembly to the hinge with MS20426AD3-4 rivets (4x).

6.1.8.3 Attach the link of the holder assembly to the servo actuator. Use retained hardware from disassembly.

6.1.9 Install new landing light assembly (P/N 4230090-7).

6.1.9.1 Route the wire bundle through the holder assembly and connect the terminal rings to the screw terminals on the back of the landing light. NOTE POLARITY (connect the 1L101A14 wire to the positive terminal ('+'), left side).

6.1.9.2 Push the wire bundle in the landing light housing. Allow slack to prevent tugging of the wires on the housing when the landing light is extended or retracted. Otherwise, some slack can be pushed back through the grommet located on the side of the housing.

6.1.9.3 For security, cable tie the wire bundle to the housing grommet with kit-supplied cable ties.

6.1.10 Install new bezel clamp (P/N 4212103-31).

6.1.10.1 Install the bezel clamp with kit-supplied AN526-632R7 screws (4x).

6.1.11 Test per step 6.3.

6.1.12 Reinstall the landing light stop.

6.2 Upgrading a Rev. A or Rev. B landing light to Rev. C:

6.2.1 Perform steps 6.1.1 through 6.1.3.

6.2.2 Remove the existing landing light:

6.2.2.1 Pull the landing light assembly forward to access the wiring.

6.2.2.2 Mark the wires with a temporary label to identify the correct polarity on reinstallation.

6.2.2.3 Disconnect the wiring at the terminals.

6.2.2.4 Remove the landing light.

August 21, 2019

6.2.3 Modify the holder plate (P/N 4212103-33):

NOTE: Place a cloth underneath the holder plate to catch the filings produced in step 6.2.3.1

6.2.3.1 Using an appropriate size metal file, gently file a notch in the holder plate to the dimensions specified in Figure 5 to accommodate the keyway on the Rev. C assembly.

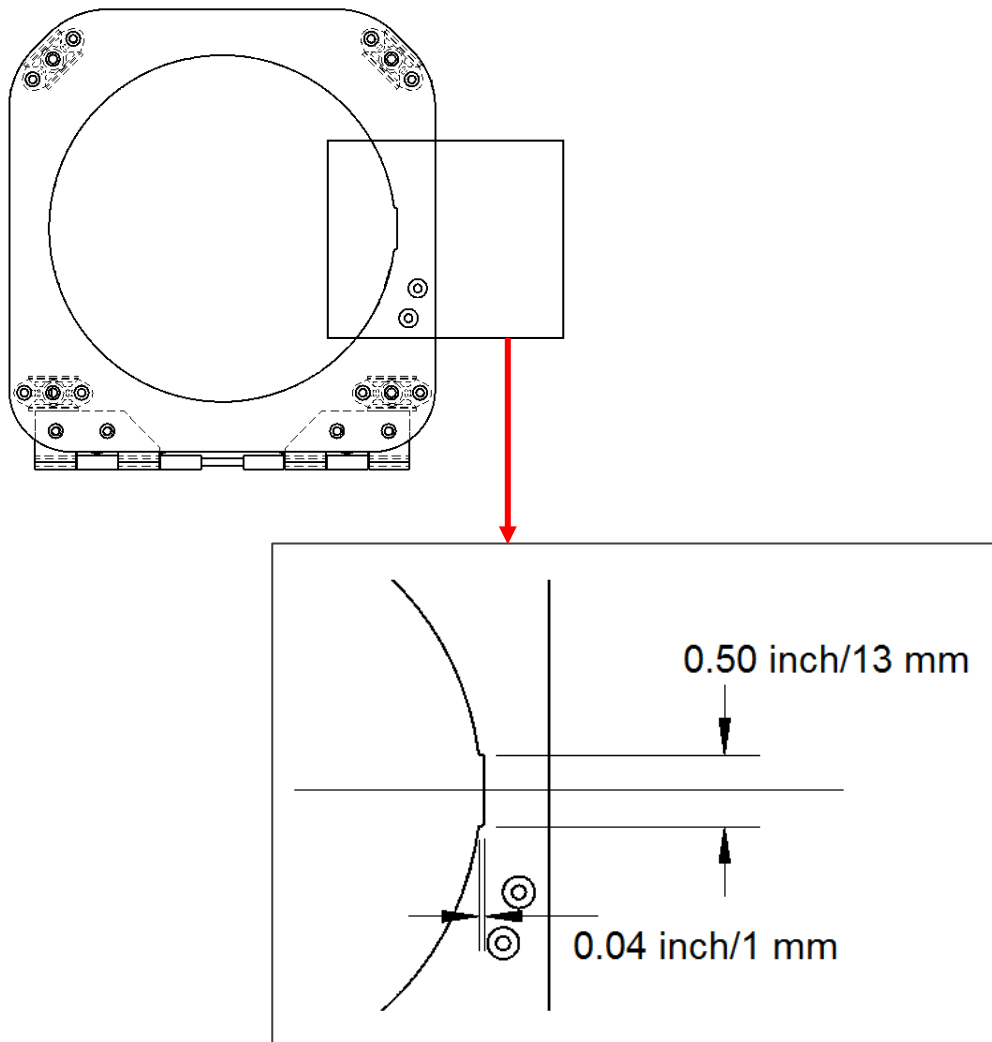

Figure 5. Notch Filed in Holder Plate

6.2.4 Install the Rev. C landing light.

6.2.4.1 Replace sleeving, if required.

August 21, 2019

6.2.4.2 Connect the terminal rings to the screw terminals on the back of the landing light. **NOTE POLARITY** (connect the 1L101A14 wire to the positive terminal ('+'), left side).

6.2.5 Test per step 6.3.

6.3 Test instructions:

6.3.1 Verify landing light illumination and position operation.

6.3.1.1 Remove any power off safety measures.

6.3.1.2 Apply power to the aircraft.

6.3.1.3 Place the landing light switch ON. Verify the landing light illuminates.

6.3.1.4 Retract and extend the landing light by pressing the landing light position switch UP, then DOWN. Verify the landing light moves upward, then downward.

6.3.1.5 Place the landing light switch OFF. Verify the landing light extinguishes.

7. PARTS

NOTE: Paint/painting is the installer's responsibility.

7.1 4230090-1 Kit – Landing Light Electrical/Mechanical Installation

7.1.1 Assemblies and hardware are included with kit 4230090-1. The kit also includes drawings and a process specification to assist with the installation.

7.1.2 Paint/painting is supplied by the installer.

8. SPECIAL TOOLS OR EQUIPMENT: None

9. MAN-HOURS: Installation – 1 hour

10. WARRANTY: Per Enstrom Helicopter Warranty policy

11. WEIGHT CHANGE: N/A

12. LOG BOOK ENTRY: As required for maintenance actions

13. REPETITIVE INSPECTIONS: None